

INDIAN (50'W) TRAILS DRIVE

INDIAN TRAILS CONDOMINIUMS  
P.B. 199 PG. 53

N00° 37'15"E  
683.97'

2.823 ACRES

S00° 31'00"W 680.56'  
DIELMAN (VARYING WIDTH) ROAD  
(FORMERLY ELMWOOD AVENUE)

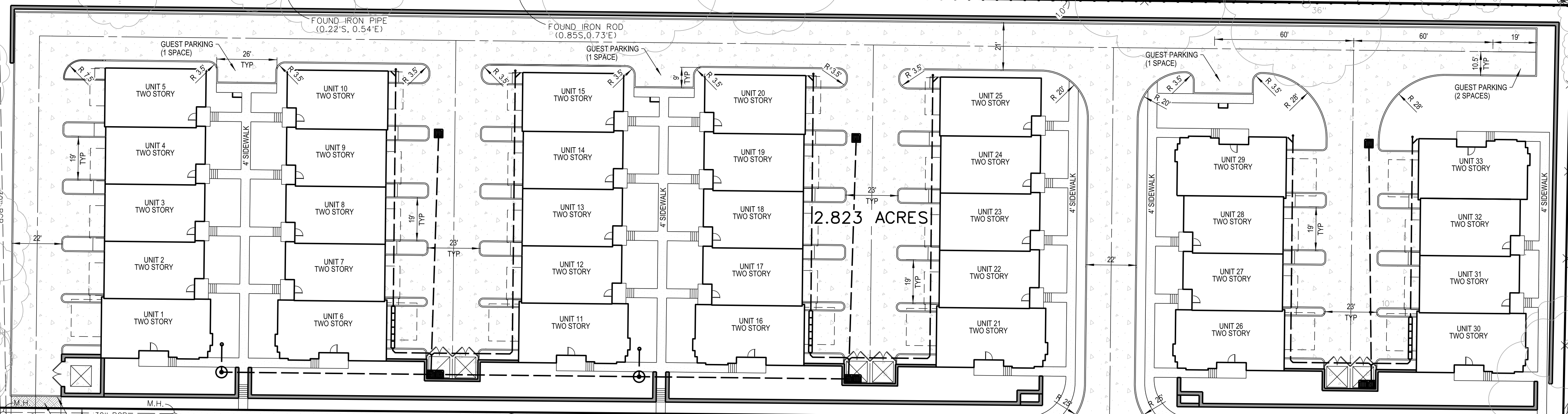

H:\CAD\22000-22999\22091\mplan\22091\_003\_Site Plan.dgn - Default 9/15/2022 5:06:17 PM Plotted by rholmes Plot Scale: 30.00000 / in. Plot Driver: vplot5.plt, pld.ctb File: Table: vplot5.plt, rbl

**DOUGLAS PROPERTIES**  
P.O. BOX 16001  
ST. LOUIS, MO 63116  
(314) 261-2411

**VOLZ Incorporated**  
ENGINEERS  
LAND PLANNING  
AND SITE DESIGN  
CONSTRUCTION  
MANAGEMENT  
10949 Indian Head In'tl. Blvd.  
St. Louis, Missouri 63132  
314.850.1260 Fax  
www.volzinc.com  
Authority #203

**NOT APPROVED  
PRELIMINARY  
FOR CONSTRUCTION**

**RYAN L. HOLMES**  
Professional Engineer  
PE-2017018988

**OLIVETTE CITY CENTER TOWNHOMES**  
1115, 1121, 1125, 1131, 1137, 1141, 1145, & 1161 DIELMAN RD.  
OLIVETTE, MISSOURI 63132

**SITE PLAN**

Base Map No. 17L  
MSD RECORD # XMSD-00XXX  
Project # 22981



CALL MISSOURI ONE CALL SYSTEMS INC. TWO FULL WORKING DAYS IN ADVANCE OF STARTING

THE UNDERGROUND UTILITIES SHOWN HEREIN WERE PLOTTED FROM AVAILABLE INFORMATION AND DO NOT NECESSARILY REFLECT THE ACTUAL EXISTENCE, OR NON EXISTENCE, SIZE, TYPE, NUMBER, OR LOCATION OF THESE OR OTHER UTILITIES. THE GENERAL CONTRACTOR SHALL BE RESPONSIBLE FOR VERIFYING THE ACTUAL LOCATION OF ALL UNDERGROUND UTILITIES IN THE FIELD, SHOWN OR NOT SHOWN, PRIOR TO ANY GRADING, EXCAVATION, OR CONSTRUCTION OF IMPROVEMENTS. THESE PROVISIONS SHALL IN NO WAY ABSOLVE ANY PARTY FROM COMPLYING WITH THE UNDERGROUND FACILITY SAFETY AND DAMAGE PREVENTION ACT, CHAPTER 319, RSMO.

09/15/2022  
7